

ProSpex Micro40 Slot Accent



40mm (1.57") overall diameter. Fully recessed Micro40 downlight for interior installation. Available with standard trim kit or plaster-in kit for flush appearance. 20° with standard ceiling thickness with no chamfer (Diagram 1), 45° tilt max with chamfered ceiling (Diagram 2), When using trimless kit max tilt 10° (Diagram 3). Family of matching products also available. Required depth height + 10mm^

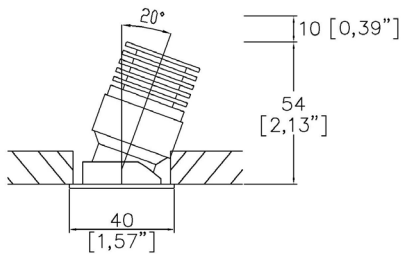

Diagram 1
M43-SA-TR
Cut-out 36mm Ø

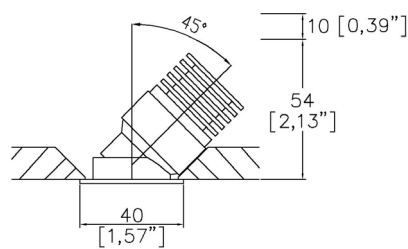

Diagram 2
M43-SA-TR
Cut-out 36mm Ø

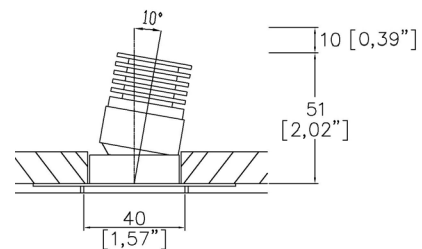

Diagram 3
M43-SA-TL
Cut-out 37mm Ø

LED Source	LED	LED	LED
CCT	3000K	3000K	3000K
Drive Current	350mA	350mA	350mA
Power inc Driver	4.65W	4.65W	4.65W
Beam Angle	15°	25°	30°
Delivered Lumens	246		
Delivered Intensity cd	3621		
Efficacy lm/w	53		
Forward Volt	11.3V	11.3V	11.3V
CRI	≥90 CRI	≥90 CRI	≥90 CRI

Project Ref: _____

Location Ref: _____

Fixture Order Code: **M43-SA** - [] - [] - [] - [] - **350** - []

Fixture
M43-SA Micro40 Slot Accent

Installation
TR Trim
TL Trimless

CCT
27 90 CRI 2700K
30 90 CRI 3000K
40 90 CRI 4000K

Finish
WH White
BK Black

Beam
15 15°
25 25°
30 30°

Drive Current
350 350mA

Protocol
S Non-Dim
A Analogue (0-10v)
P Phase
D DALI
B Bluetooth**

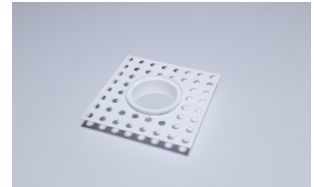

Technical Details

*Custom RAL code must be specified. Custom RAL colours can increase prices and lead times

Dimming. Whilst Lucent can offer the majority of its luminaires with various dimming options, it remains the responsibility of the specifier/installer to check and ensure compatibility of any control equipment used. Additional cabling may be required depending on the dimming protocol specified.

**Bluetooth (wireless) is the communication method. The exact dimming protocol must be confirmed to allow the selection of suitable drivers or bluetooth devices.

^ Depth indicated is the minimum recess depth for the luminaire with a remote mounted LED driver. Installing a driver through either the luminaire cut-out or installation kit may require additional recess depth, please refer to the relevant luminaire installation instructions for further details. Data correct at time of publishing

First Fix Requirement. Luminaire comprised of fixture body with ceiling trim and installation kit, which is to be fitted into the ceiling once finished. Ensure correct alignment of the installation kit before final assembly (see luminaire installation instructions for details)

IP Rating. Tested from underside of the ceiling

It is the policy of Lucent Lighting to continually review and improve its products and therefore reserve the right to change any details of product or withdraw specifications without prior notice.

Luminaires designed to comply with EN60598 and all other standards.

This specification sheet supersedes all previous versions.

All intellectual property rights pertaining to the product described above and to this document are owned by or licensed to Lucent Lighting Ltd.

We reserve the right to take whatever action is necessary to protect those intellectual property rights.

Please notify Lucent Lighting Ltd of any inaccuracies immediately. E&OE