

Flaplight System

Linear display lighting system



RADIANT

Flaplight System Linear Display Lighting System

The Radiant LED Flaplight system has been developed for use in a wide variety of linear display and picture lighting applications including museums, galleries and retail.

The extruded head incorporates adjustable and lockable hinged flaps to control glare and cut off to ensure excellent visual comfort.

The lighting head can be fitted with a variety of lenses to control the light distribution from the LEDs.

The head can rotate between the fixing brackets and can be locked at the correct aiming angle with an Allen key.

The LEDs are driven at the correct power by integral LV constant current drivers which are dimmable, via a separate Radiant interface, with all systems including 1 - 10 V, DALI and DMX.

Input voltage is 15 V DC and the remote power supplies can be located up to 50 mtrs from the luminaires.

Either 25 mm or 50 mm LED pitch can be supplied depending on the light level required. Overall lengths are based on a 25 mm module and the metal work can be anodized / plated or painted to any RAL colour.



Twin desk mounted task light
RAD Flap TDT 40
Supplied in 1.0 mtr lengths as standard
Lengths based on 100 mm module to order

Lenses available in elliptical, wide, medium and narrow distributions
Add E,W,M or N to product number
Integral LV constant current driver
8 Watts per 100 mm. 15 Volt DC Supply
Silver anodized finish as standard
RAL colours to order



Single desk mounted task light
RAD Flap SDT 40
Supplied in 1.0 mtr lengths as standard
Lengths based on 100 mm module to order

Lenses available in elliptical, wide, medium and narrow distributions
Add E,W,M or N to product number
Integral LV constant current driver
4 Watts per 100 mm. 15 Volt DC Supply
Silver anodized finish as standard
RAL colours to order



Picture light twin arm
RAD Flap PLD 40
Supplied in 0.3 mtr lengths as standard
Lengths based on 100 mm module to order

Lenses available in elliptical, wide, medium and narrow distributions
Add E,W,M or N to product number
Integral LV constant current driver
4 Watts per 100 mm. 15 Volt DC Supply
Silver anodized finish as standard
Plated, anodized and RAL colours to order



Pendant
RAD Flap Pendant 40
Supplied in 1.0 mtr lengths as standard
Lengths based on 100 mm module to order

Lenses available in elliptical, wide, medium and narrow distributions
Add E,W,M or N to product number
Integral LV constant current driver
4 Watts per 100 mm. 15 Volt DC Supply
Silver anodized finish as standard
RAL colours to order



Wall mount
RAD Flap WM 40
Supplied in 1.0 mtr lengths as standard
Lengths based on 100 mm module to order

Lenses available in elliptical, wide, medium and narrow distributions
Add E,W,M or N to product number
Integral LV constant current driver
4 Watts per 100 mm. 15 Volt DC Supply
Silver anodized finish as standard
RAL colours to order



Picture light single arm
RAD Flap PLS 40
Supplied in 0.3 mtr lengths as standard
Lengths based on 100 mm module to order

Lenses available in elliptical, wide, medium and narrow distributions
Add E,W,M or N to product number
Integral LV constant current driver
4 Watts per 100 mm. 15 Volt DC Supply
Silver anodized finish as standard
Plated, anodized and RAL colours to order



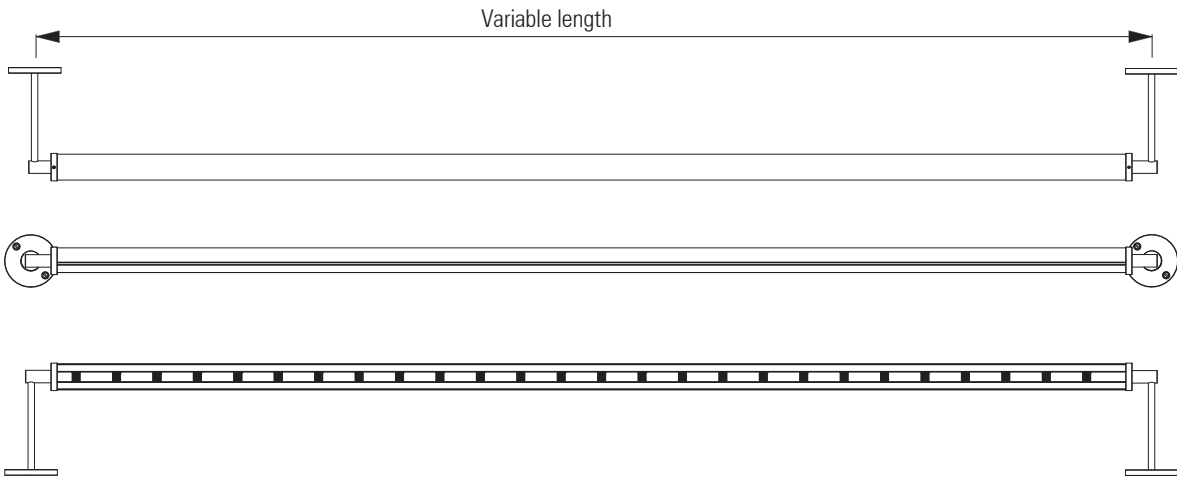

General arrangement

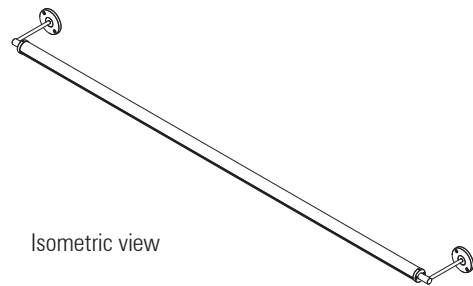
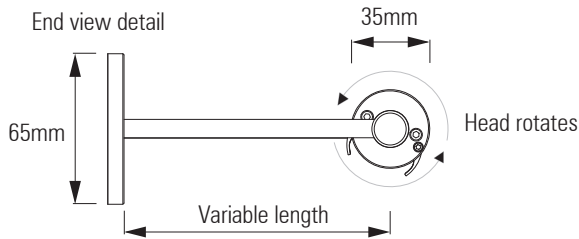

Isometric view

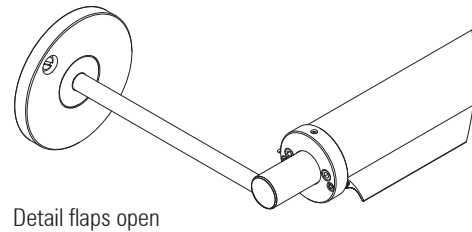
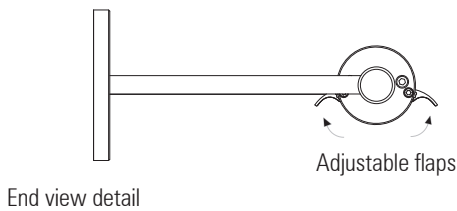

Detail flaps open

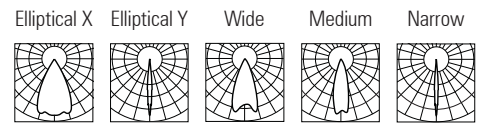

Create an order-code by selecting one option from each column in the table below.
 eg. FLAPLIGHT . IP20 . 4 . 600mm . 27K . CRI 80 . E . Pendant . End . Black .

Product Code	IP	No. of LEDs per 100mm	Length (mm)	Colour Temp. (K)	CRI	Optics	Feed	Bracket Type	Finish
FLAPLIGHT	20	4=25mm 2=50mm LED spacing	200mm to 1800mm Increments of 100mm	27 =2,700K 30 =3,000k 35 =3,500k 40 =4,000k 45 =4,500k 50 =5,000k Dynamic white	80 90	120° E W M N	End Side Back	Twin desk task-light Single desk task-light Pendant Wall mount Picture light twin arm Picture light single arm Undercabinet	Black White Any RAL-colour Anodized Plated Polished Satin

Radiant Architectural Lighting
 10 Broadbent Close
 20 - 22 Highgate High Street
 London N6 5JW
 ENGLAND UK

T: + 44 (0) 20 8348 9003
 F: + 44 (0) 20 8348 6478
 E: david@radiantlights.co.uk
 www.radiantlights.co.uk

Products and literature designed by
DAVID MORGAN ASSOCIATES
 July 2015

