

## instruction manual MinimoTilt Trimless

Minimo Eye is a miniature recessed 95 CRI LED luminaire offering 360° pan coupled with 30° tilt.

Minimo - 1.6W, 140lm

**Remote access required for driver.**



Constant current fixtures. Use with an appropriate 500mA LED driver as recommended by Precision Lighting only.

### PRINT TO SCALE TO ENSURE CUT-OUT STENCIL ACCURACY

42 RIVERSIDE ROAD | LONDON | SW17 0BA | UK  
t. +44 (0) 20 8947 6616 | sales@precisionlighting.co.uk  
f. +44 (0) 20 8286 6626 | www.precisionlighting.co.uk  
© 2015 Precision Lighting Ltd. We reserve the right to change details of design, materials and finish. Version 1.0

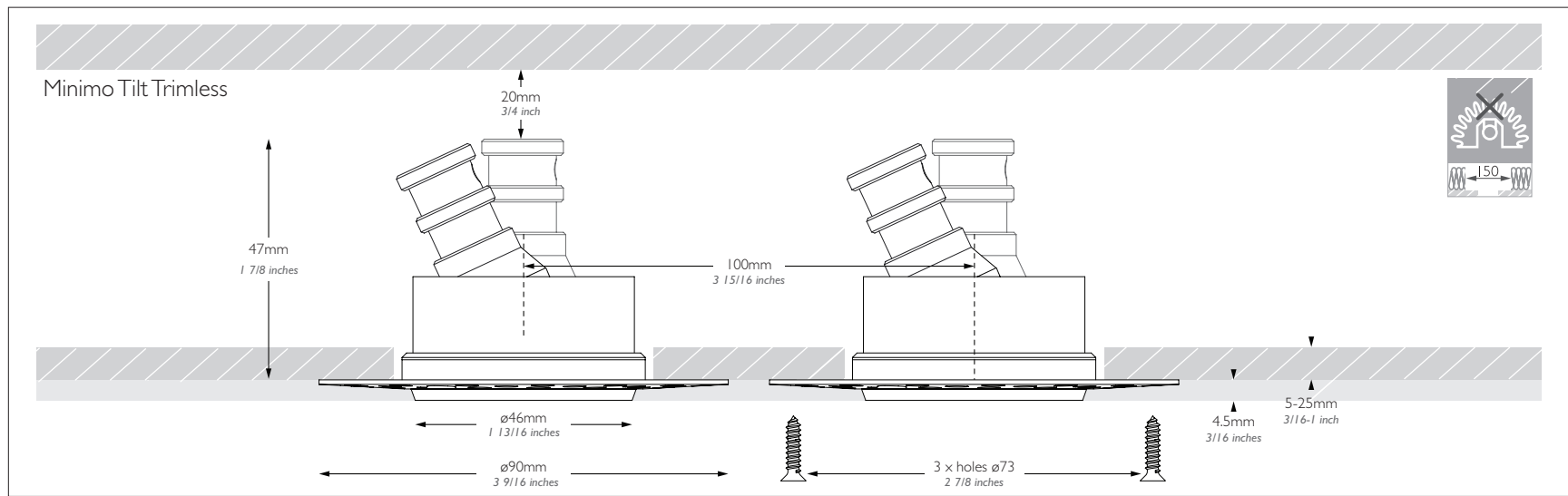

| Compatible Power Supply       | Order Code       | Luminaire Quantity |
|-------------------------------|------------------|--------------------|
| Microjolly 500mA 6W 1-10V Dim | PSCC-06-500-A-TC | 1-3                |
| Harvard 500mA 24W 1-10V Dim   | PSCC-24-500-A-HA | 3-14               |
| Harvard 500mA 10W DALI Dim    | PSCC-10-500-D-HA | 3-6                |
| Harvard 500mA 24W DALI Dim    | PSCC-24-500-D-HA | 6-14               |

Cut-out stencil ø57  
2 1/4 inch

## IMPORTANT SAFETY INFORMATION

READ ALL INSTRUCTIONS BEFORE USING THESE PRODUCTS. SAVE THESE INSTRUCTIONS FOR LATER REFERENCE.

- All systems must be installed by a suitably qualified professional only. Installations must conform to national installation and accident prevention regulations.
- Ensure that the luminaire is switched off at mains supply before installing or removing.
- Do not install these systems in a damp or wet location, IP20 environments only. Do not install any fixture closer than 150mm (6 inches) from any combustible material.
- To reduce the risk of fire and burns, do not install these systems where exposed bare conductors can be shorted or contact any conductive materials. Do not conceal or extend exposed conductors through a building wall.
- Ensure all connections are tight. Bad connections can cause overheating, arcing and a potential fire risk.
- Wire supply connections must be made with U.L. or compatible testing agency-approved connectors. Always use appropriate optics and ensure they are fitted securely.
- Install and use only as described in this Precision Lighting manual.
- Use Precision Lighting recommended optics and accessories only.
- Luminaires may be hot, allow to cool before touching.
- Access to serviceable electrical components should be kept available for maintenance purposes.
- Regular cleaning of these products is important. Switch off at mains supply and allow to cool before touching. Clean fittings with a microfibre cloth. Then reconnect the power supply.

**WARNING** Do not connect or disconnect under load. Ensure driver has not been powered for a minimum of 1 minute before reconnecting the LED module after disconnecting. Do not hot plug. Failure to follow this instruction will lead to serious damage of the LED module and driver and will not be covered by warranty.

**NOTE** Maintain correct polarity when wiring. Incorrect wiring will cause serious damage and will not be covered by warranty. Must be installed according to SELV regulations. Wire specification: 22 AWG,  $\varnothing$ 0.65mm diameter double insulated teflon wire. Red - Positive Black - Negative

**NOTE** LED module is not site serviceable. Tampering will cause damage and will not be covered by warranty.

### I. Installing the luminaire

**WARNING** switch off power to mains before installation.

Remove LED module from fitting by pushing down on LED module from the back of the fixture.

Cut hole  $\varnothing$ 57 (2 1/4 inches). Insert driver through cutout if not already in position. Driver dimensions shown are for the 6W Microjolly PSCC-06-500-A-TC.

Position plaster-in ring and use appropriate fixings to secure to ceiling.

Pull driver side connector through hole.

Apply plaster over plaster-in ring and skim. Avoid covering wires with plaster. Cut around the inside of the aperture to ensure a neat finish.

Once plaster is dry, ensure control gear is not connected to mains supply before attaching the luminaire side connector to the driver side connector.

Insert LED module (facing correct direction) into plaster-in housing by pushing upwards and allow the fixture to magnet in place.

To alter the tilt direction hold the bezel and turn the fixture in the ceiling, to face the correct direction.

To alter the tilt angle, push the LED module to the correct angle.

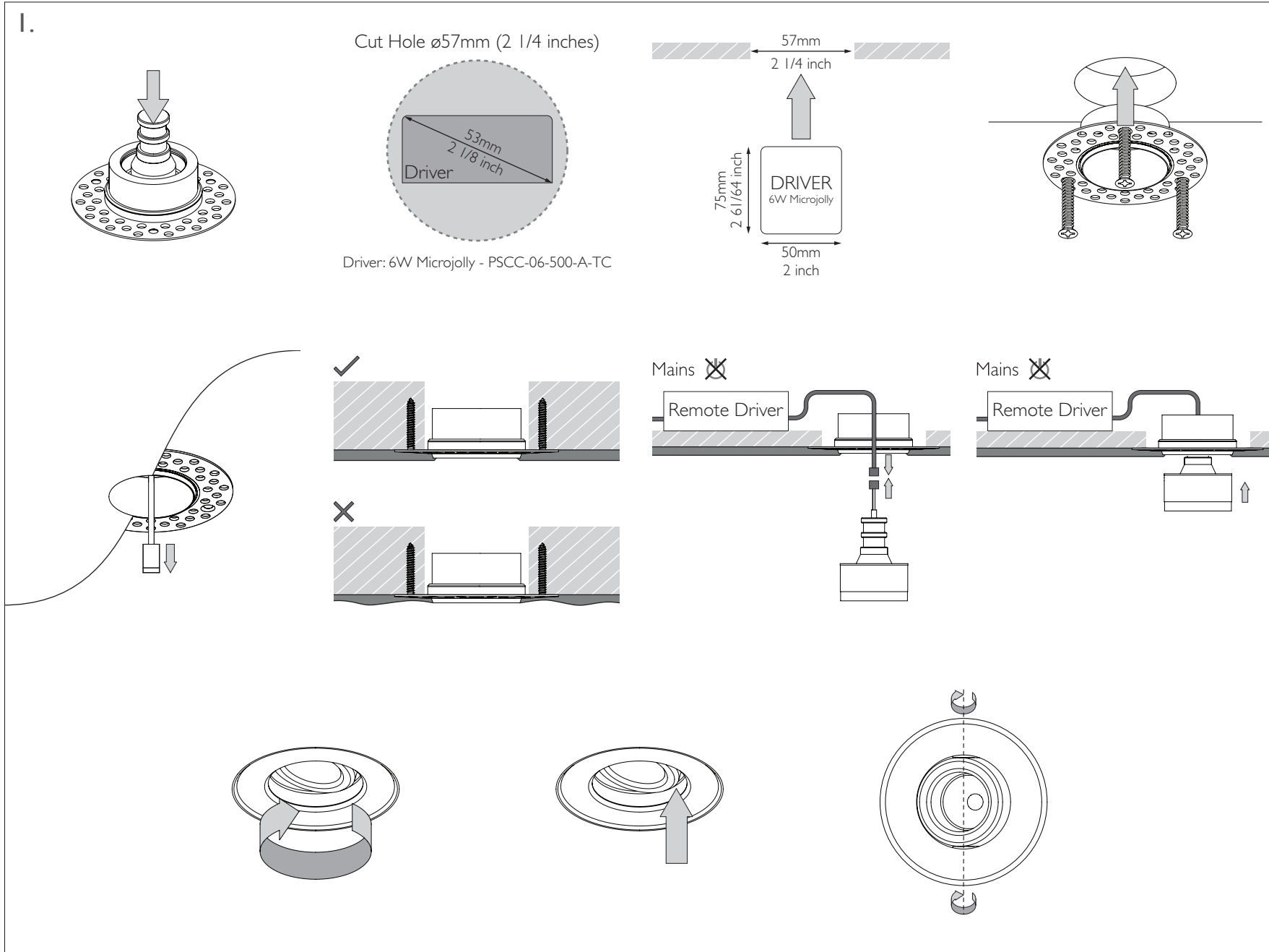

**WARNING** Do not connect or disconnect under load.  
Ensure driver has not been powered for a minimum of 1 minute before reconnecting the LED module after disconnecting. Do not hot plug. Failure to follow this instruction will lead to serious damage of the LED module and driver and will not be covered by warranty.

**NOTE** Maintain correct polarity when wiring. Incorrect wiring will cause serious damage and will not be covered by warranty. Must be installed according to SELV regulations.  
Wire specification: 22 AWG,  $\varnothing 0.65\text{mm}$  diameter double insulated teflon wire.  
Red - Positive      Black - Negative

**NOTE** LED module is not site serviceable.  
Tampering will cause damage and will not be covered by warranty.

## 2. Changing the optic

**WARNING** luminaire may be hot.  
Allow to cool before touching.

Remove LED module from the housing.  
Hook a finger over the lip of the bezel and pull the fixture downwards until the LED module is clear of the housing.

Remove the heat sink by unscrewing.

Remove the optic with a sharp pull. Do not twist the optic during removal. Note the detail on the underside of the optic. The 2 side cavities on the optic must be placed over the solder pads of the PCB

Press the optic onto the PCB and hold for 10 seconds.

Screw the heatsink back into the LED module.

**WARNING** Do not overtighten

Return the LED module to the housing and allow to magnet in place.

2.

