

# TROLI

Simple and Reliable Bollard Family

CE UK CA IK05 IP65



The combination of traditional clean looks with a unique lighting approach makes TROLI stand out to illuminate pathways, landscaped areas, and other public spaces.

- Equipped with HEPER's Hybrid (HYB) module
- Optimized light distribution with secondary reflector technology
- Easy installation and maintenance

Product code	Product name	Light distribution	Delivered lumens flux	Rated input power	Colour temperature	Control	Weight
LB6009.693-EN	TROLI	[SYM-3L] 165°	444 - 541 lm	10 W	2700 K CRI 80, 3000 K CRI 80, 4000 K CRI 70, 4000 K CRI 80	On/Off, DALI	4.42 kg
LB7032.693-EN	TROLI S	[SYM-3L] 165°, [SYM-3L-2] 360x165°	444 - 541 lm	10 W	2700 K CRI 80, 3000 K CRI 80, 4000 K CRI 70, 4000 K CRI 80	On/Off	2.52 kg

LB6009.693

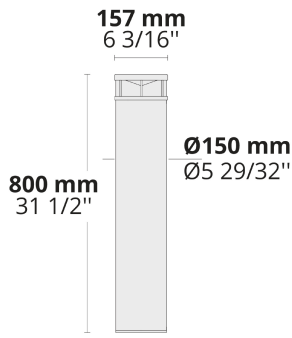

LB7032.693

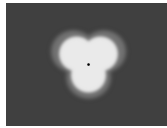
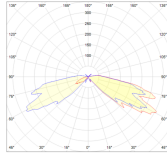
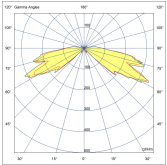
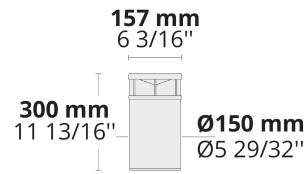

[SYM-3L]

Symmetric,  
Special effect: 3  
lines

[SYM-3L-2]

Symmetric,  
Special effect: 3  
lines

## Extras

Luminaire body options

DPC

DPC

Double powder  
coating

## Accessories (To be ordered separately)

Anchorage

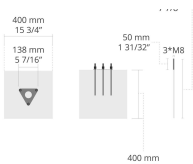

612J014

612J014

HPR Pazarlama A.Ş.  
Başkent OSB 22. Cd. No: 2, Malıköy, Temelli,  
Sincan, 06909 Ankara, Turkey  
+90 312 267 54 30  
info@hepergroup.com

HEPER Europe GmbH  
Ahornweg 5a, 58675  
Hemer, Germany  
+49 237 2901 2975  
infoEU@hepergroup.com

We reserve the right to change specifications  
without prior written notice. Edition: 12.01.2024.  
For current version visit [heperlighting.com](http://heperlighting.com). All  
flux ( $\pm 7\%$  tolerance) and power values ( $\pm 10\%$   
tolerance) are derived following appropriate IES,  
CIE, and applicable standards.

