

Microline

Spot



Body

Surface mounted LED system in extruded aluminium.
Available in different length configurations starting from 85mm with increment of 80mm.
Section 14x13mm.
Constant 40mm pitch between the LED.

Mounting options:
Integrated magnets for easy installation.
L mounting brackets.
U mounting clips.

*** Plastic free packaging.**

Accessories

Mounting accessories included.
Power extension cable Art. 2C47 to be ordered separately.

Finish

Anodized black, white, brass polished, gold or aluminium finish. Other finish options available on request.

LED sources

Power LED.
CRI: 75 & 97 | R9: >90 | CCT: 2100K, 2400K, 2700K, 3000K, 3500K, 4000K.
3-Step MacAdam
Other CRI and CCT options available on request.

Optic

Lens.
Beam angle: 21° / 29° / elliptical (22° x 47°).

Driver

Driver not included to be ordered separately.
Work with 700 mA Constant Current Driver positioned remotely.

Applications

Miniature linear light with a disappearing look emitting a spot light. Ideal solution for display showcase and under cabinet illumination.
Application areas: Retail, cabinet displays, showcases, jewelry displays, residential, restaurants, museums.

Related Products

Microline
Ø14 

Microline
Ø14 Chain 

Microline
Spot Chain 

Microline Spot | G426



Min. L= 85mm (3.34"), 2 LED

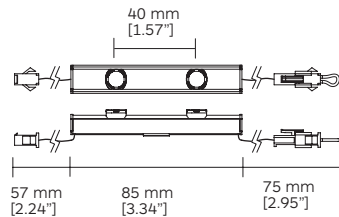

Max. L= 1285mm (50.59"), 32 LEDs

Mounting options

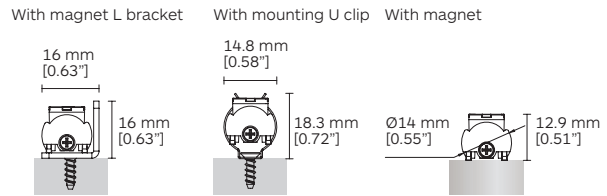

Increment: 80mm (3.14"), 2 LEDs

Available length codes ¹

No. of LEDs	Voltage	LED Power	Length code	Length in mm	Length in inches	Nominal Lumen	No. of LEDs	Voltage	LED Power	Length code	Length in mm	Length in inches	Nominal Lumen
2	3.2V	2.00W	0085	85	3.35	180 lm	18	28.8V	18.00W	0725	725	28.54	1620 lm
4	6.4V	4.00W	0165	165	6.50	360 lm	20	32V	20.00W	0805	805	31.69	1800 lm
6	9.6V	6.00W	0245	245	9.65	540 lm	22	35.2V	22.00W	0885	885	34.84	1980 lm
8	12.8V	8.00W	0325	325	12.80	720 lm	24	38.4V	24.00W	0965	965	37.99	2160 lm
10	16V	10.00W	0405	405	15.94	900 lm	26	41.6V	26.00W	1045	1045	41.14	2340 lm
12	19.2V	12.00W	0485	485	19.09	1080 lm	28	44.8V	28.00W	1125	1125	44.29	2520 lm
14	22.4V	14.00W	0565	565	22.24	1260 lm	30	48V	30.00W	1205	1205	47.48	2700 lm
16	25.6V	16.00W	0645	645	25.39	1440 lm	32	51.2V	32.00W	1285	1285	50.59	2880 lm

Code ordering example: **G 4 2 6 0 0 8 5 - 9 7 2 7 2 1 0 0 1 0**

	Product code*	Length code***	>CRI	CCT**	LED Power	Nominal Lumen	Beam angle (BA°)	Driver Options	Finish
Microline Spot	G426	Min. 0085	97	27 2700K	1W/LED	90 lm/LED	21 / 29 / EL	00 No Driver	10 ■ Black
		⋮		30 3000K					11 □ White
		Max. 1285		35 3500K					28 ■ Brass Polished
				40 4000K					35 ■ Gold
			75	21 2100K		121 lm/LED			70 ■ Aluminium
				24 2400K					

Notes:

¹ Information in the chart above is related to 3000K LED.

Driver Options

Constant Current

Microline Spot



L
N
Dim

Art. 2C07D0 (On/Off)
Art. 2C07D1 (0-10V)
Art. 2C07DA (DALI)

2C07 Constant Current LED Driver. 1 Driver can drive 2-32 LEDs, about 1285mm Max.

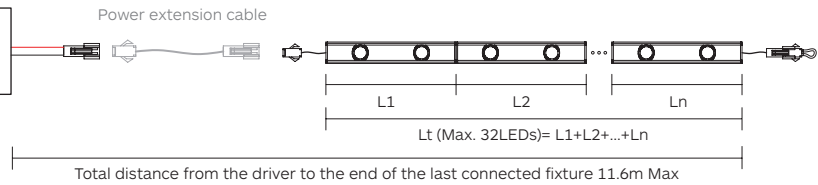

G426

Power extension cable. Art. **2C47**. 1m (if necessary).

Vin= 180~277V AC 50/60Hz
Iout= 700mA V=2~57V
P= 40W Max.
Dimensions: 123.5x81.5x23mm
IP20